

EX15L 1150X560

CONVENIENT, EASY TO USE, LI-ION BATTERY



EX15L

The economical solution for light logistics operations. Easy to use thanks to the technical features that characterize it: compact size, significantly reduced weight, powered by a powerful lithium battery that can be removed by means of a rapid vertical extraction system. The machine can easily carry loads up to 1500 kg.



24V/20 Ah



4,5/5,0 km/h



1500 kg



CONVENIENT

MANOEUVRABILITY

The overall width of the machine matches with the fork width (560 mm).

This makes the unit as compact as possible and, together with the reduced turning radius (1330 mm), enables to work in narrow spaces.



ROBUSTNESS

Robust frame designed to guarantee maximum durability and resistance to torsion and loads.

Fork tips shaped for an easier entrance/exit on the closed side of the pallet.



SAFETY

Emergency push button, belly button and electrobrake are the standard safety features of the machine.

The cover for driving wheel protects the operator's feet during work and secures the truck's components from collision with objects.

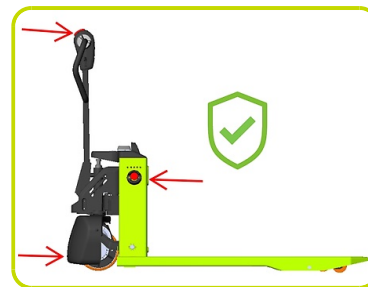

TURTLE MODE SWITCH

Offered as standard, this function enables operating the truck in confined spaces: it allows the unit to travel with the tiller in upright position.

This function is activated by pressing the turtle button on the tiller. The truck travels at limited speed.

Release the button to disable this function.



PLUG-IN & OUT LI-ION BATTERY

The new improved plug-in&out system enables an easy battery replacement in just few seconds, without using any cables.

The machine can also be equipped with a second extra battery, allowing continuous and non-stop work.

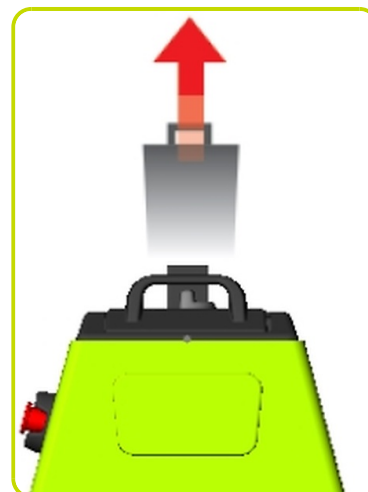

EASY MAINTENANCE

Simple construction with a design that allows a really easy maintenance.

The access to motorwheel can be done just removing few bolts and without lifting the unit.

Maintenance-free Li-Ion battery.



OPTION

Stabilizing wheels: to enable movement even on more difficult surfaces, ensuring maximum stability in any condition of use.



Descriere

Stivuitor			ELECTRICĂ
1.3 Comandă			ELECTRICĂ
1.4 Poziție operare			Pedestru
1.5 Capacitate maximă	Q	Kg	1500
1.6 Distanța la centrul de aplicare al sarcinii	c	mm	600
1.8 Sarcina de la osie la capătul furcilor	x	mm	950
1.9 Ampatament	y	mm	1190

Greutăți

2.1 Greutate de operare (acumulator inclus)		Kg	120
2.2 Sarcină osie, încărcare pe spate		Kg	1140
2.2 Sarcină osie, încărcare pe față		Kg	480
2.3 Sarcină osie, liber față		Kg	90
2.3 Sarcină osie, liber spate		Kg	30

Cauciucuri/Șasiuri

3.1 Cauciucuri: roți direcție			POLY.C
3.1 Cauciucuri: transportoare cu role			POLY
3.2 Mărime cauciuc: roți direcție - Lățime		mm	70
3.2 Mărime cauciuc: roți direcție - Diametru		mm	210
3.3 Mărime cauciuc: transportoare cu role - Diametru		mm	80
3.3 Mărime cauciuc: transportoare cu role - Lățime		mm	60
3.5 Dimensiune cauciuc: roti spate		nr	4
3.5 Dimensiune cauciuc: roti fata		nr	1x
3.7 Ecartament, spate	b11	mm	410

Dimensiuni

4.4 Înălțime stivuitor	h3	mm	115
4.9 Înălțime manetă în poziția de deplasare, max	h14	mm	1190
4.9 Height of tiller in drive position min	h14	mm	750
4.15 Înălțime, coborât	h13	mm	80
4.19 Lungime globală	l1	mm	1540
4.20 Distanța până la suprafața frontală a furcilor	l2	mm	400
4.21 Lățime globală	b1	mm	560
4.22 Dimensiuni furcă - grosime	s	mm	50
4.22 Dimensiuni furcă - Lățime	e	mm	150
4.22 Dimensiuni furcă - Lungime	l	mm	1150
4.25 Distanța între furci	b5	mm	560
4.32 Gardă la sol și mijloc ampatament	m2	mm	30
4.34 Lățime culoar	Ast	mm	2050
4.35 Rază de virare	Wa	mm	1330

Performante

5.1 Viteză de deplasare cu incarcare	Km/h	4,5
5.1 Viteză de deplasare fără incarcare	Km/h	5,0
5.2 Viteză de ridicare, încărcat	m/s	0,017
5.2 Viteză de ridicare, descărcat	m/s	0,020
5.3 Viteză de coborâre, încărcat	m/s	0,09
5.3 Viteză de coborâre, descărcat	m/s	0,06
5.8 Tracțiune maximă în pantă (cu incarcare)	%	6
5.8 Tracțiune maximă în pantă (fără incarcare)	%	16
5.10 Frână de serviciu	ELECTRICĂ	

Motoare electrice

6.1 Putere motor comandă	kW	0,75
6.2 Putere motor stivuitor	kW	0,7
6.4 Tensiune acumulator	V	24
6.4 Capacitate acumulator, Min	Ah	20
6.4 Capacitate acumulator, Max	Ah	20
6.5 Greutate acumulator, min	Kg	7
6.5 Greutate acumulator, max	Kg	7
8.4 Nivel sonor la nivelul urechii șoferului	dB(A)	<74

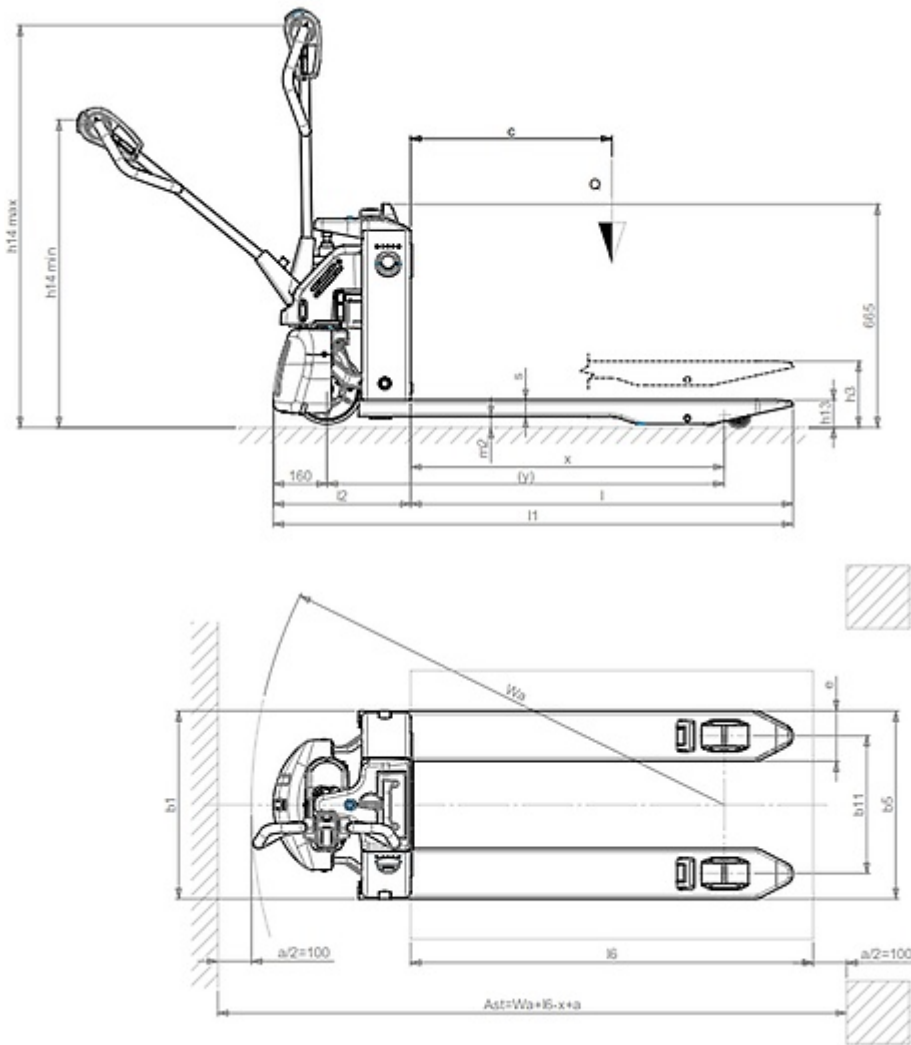

The information is aligned with the Data file at the time of download. Printed on 16/03/2023 (ID 14011)

©2023 | PR INDUSTRIAL s.r.l. | All rights reserved | Image shown may not reflect actual package. Specifications subject to change without notice

